

INSTALLATION GUIDE

SPC Wall Panels

Murèlle
WALL COVERING

Pre-installation Requirements

1.Requirements for wall

Check the level of the wall using a spirit level. Flatness deviation $\leq 2\text{mm/m}^2$, verticality deviation $\leq 2\text{mm/m}^2$.

The wall surface should be dry, free of impurities, delamination, voids, and other defects.

The moisture content of the wall should not be higher than 8%, otherwise, dehumidification should be carried out or appropriate moisture-proof measures should be taken.

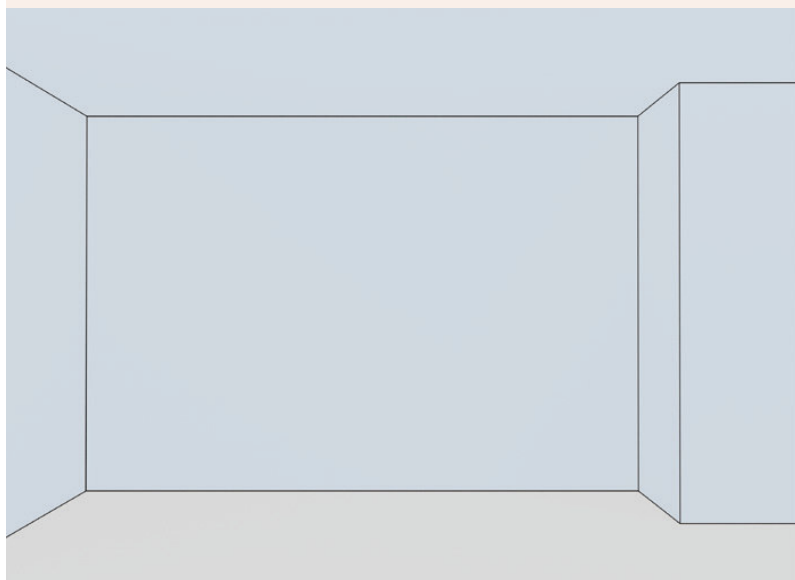

Apply a primer to the prepared substrate.

TOOLS

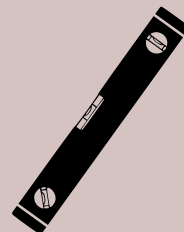

2.Requirements for temperature

The room temperature should preferably be between 15°C and 25°C for 24 hours before, during, and after installation

3.Requirements for wall panel

The wall panels are placed on the construction site for 24 hours before installation begins, in order to allow the wall panels to adapt to the site temperature

TOOLS



Installation

1.Measurement

Measure the construction height to adjust the size of the SPC panel.
Mark this height on the panel.

2.Cutting

Use the utility knife to cut along the ruler, and gently press the cutting edge (joints between panels and the groove depth of trims need to be considered)



TOOLS

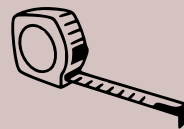

3.Apply adhesive

Apply dots or line of adhesive evenly to the back of the wall panel.
Pay attention to the spacing of the silicone adhesive to ensure that the silicone adhesive does not overflow when the wall panel is glued to the wall



If you apply dots, the spacing between individual dots is approximately 10 cm.

TOOLS



Installation

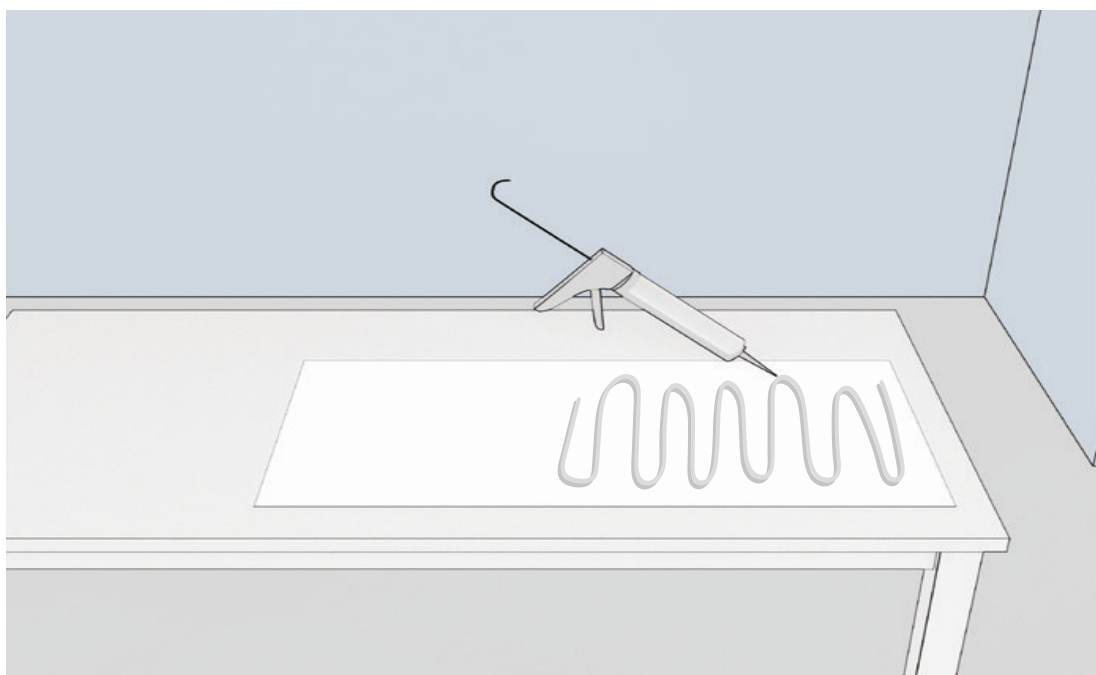

TOOLS



To glue the panels to the wall, it is necessary to apply an adhesive based on MS polymers.

4. Install the panel

Install the panel on the wall. Carefully press the panel down so that the adhesive is evenly spread under the panel.

Gradually install additional panels so that they fit into the lock.

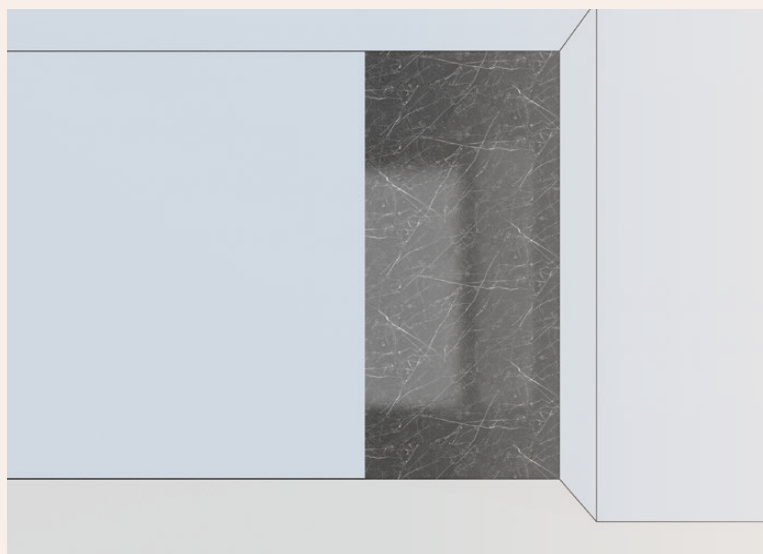

TOOLS

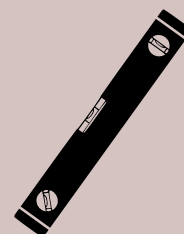

Installation



Panels with a "shiny finish" surface treatment have a protective film on the surface. This film must be removed after installation.

TOOLS



5. End trim

If the SPC wall cladding is not finished at the corners of the walls, it is necessary to use a finishing profile. Just place them in the right place on the wall panel and fix them with an adhesive.

TOOLS

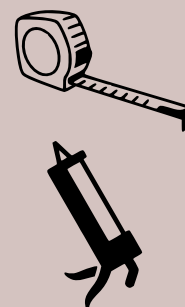
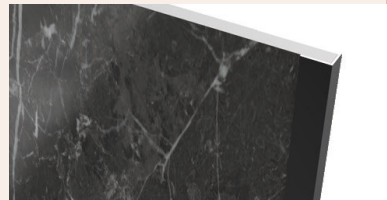
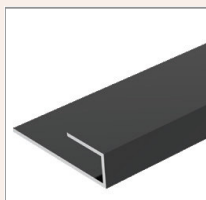

6. Final result

After the silicone adhesive has cured, you can install baseboards, or other decorative elements.

TOOLS

